

EDGE A SPECIFICATIONS

Continuous power output	100W RMS into 8 Ohms 200W RMS into 4 Ohms
THD (unweighted)	<0.002% 1kHz at rated power (8 Ohms) <0.02% 20Hz – 20kHz at rated power (8 Ohms)
Frequency Response	<3Hz - > 80kHz +/- 1dB
S/N ratio (ref full power)	>103 dB
Crosstalk @ 1kHz	<-100dB
Input sensitivity	Input A1-A2 (unbalanced) 380mV RMS
Input impedances	Input A3 (balanced) 47k Ohm Input A1-A2 (unbalanced) 47k Ohm
Inputs	Balanced, Coax SPDIF, TOSLINK, USB Audio, Unbalanced, Bluetooth, Audio Return Channel (ARC)
Outputs	Speakers, Preamplifier, Headphones (impedance of between 12 and 600 Ohms are recommended)
USB audio input	USB Audio Class 2.0 supporting up to 32-bit 384kHz pCM, or up to DSD256
Bluetooth	4.1 (Smart/BLE enabled) A2DP/AVRCP supporting formats up to aptX HD
TOSLINK input	16/24 bits, 32-96kHz
Coax SPDIF input	16/24 bits, 32-96kHz
Max power consumption	1000W
Standby power consumption	<0.5W
Dimensions	150 x 460 x 405mm (5.9 x 18.1 x 15.9")
Weight	24.4kg (53.7lbs)



INTRODUCING **EDGE A**
INTEGRATED AMPLIFIER





INTRODUCING **EDGE A**
INTEGRATED AMPLIFIER



OUR MOST DETAILED INTEGRATED AMPLIFIER.

Edge A was built with no compromise. It was made to celebrate musicality. Riffs, phrases, percussive rolls – take in every detail of your music thanks to its dynamic setup. Effortlessly powerful, but with incredible depth, the overall sound is breath-taking – like the band’s playing right in front of you.



BREATH-taking MUSICALITY

Edge A delivers a finely balanced, 'British' sound with a depth and clarity that comes through with every note.

- Edge A features a cleaner signal path, letting your music breathe.
- We developed the system by ear, testing every component and only choosing the best.



MORE MUSICAL DETAIL.

We pioneered the use of toroidal transformers in amplifiers and in Edge we take this one step further, using opposing symmetry twin toroidal transformers. The benefits of this technology include:

- Cancelling out electromagnetic interference
- Offering outstanding power
- Maintaining consistent tonality, no matter how loud it's played.

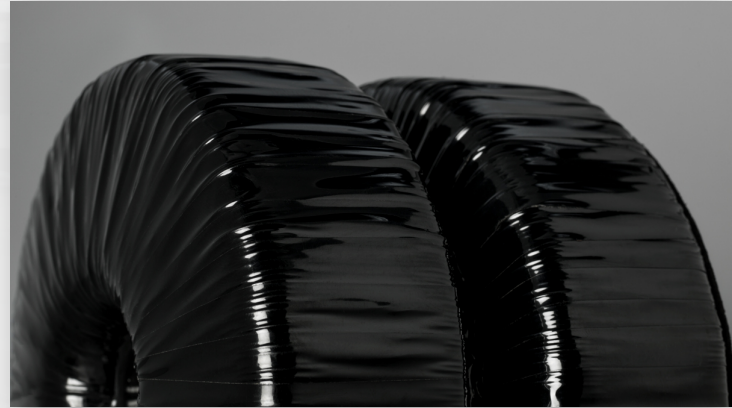

EFFORTLESS POWER WITHOUT DISTORTION.

Edge A features a unique amplification technology, reducing distortion to inaudible levels and creating a more efficient system. Class A amplifier technology wasn't efficient enough for Edge. Instead, we added a bias voltage to a traditional Class AB design, moving the crossover point out of audible range.

Benefits of our Class XA amplification include:

- Less audible distortion, even at high volumes
- Increased efficiency of the system
- Less excess heat.

HI-RES BLUETOOTH.

- Pair any Bluetooth device to your Edge A to stream your music.
- aptX HD support allows audio playback up to 24-bit/48kHz.



DUAL CONCENTRIC CONTROL KNOB

Edge A features a high-quality, dual concentric volume and source select control knob. The engineering complexity enables the most intuitive user interfaces:

- Navigate menus and control the volume with a simple twist
- Designed and assembled in the UK from 31 precision-milled engineered parts
- Made from aerospace-grade materials.

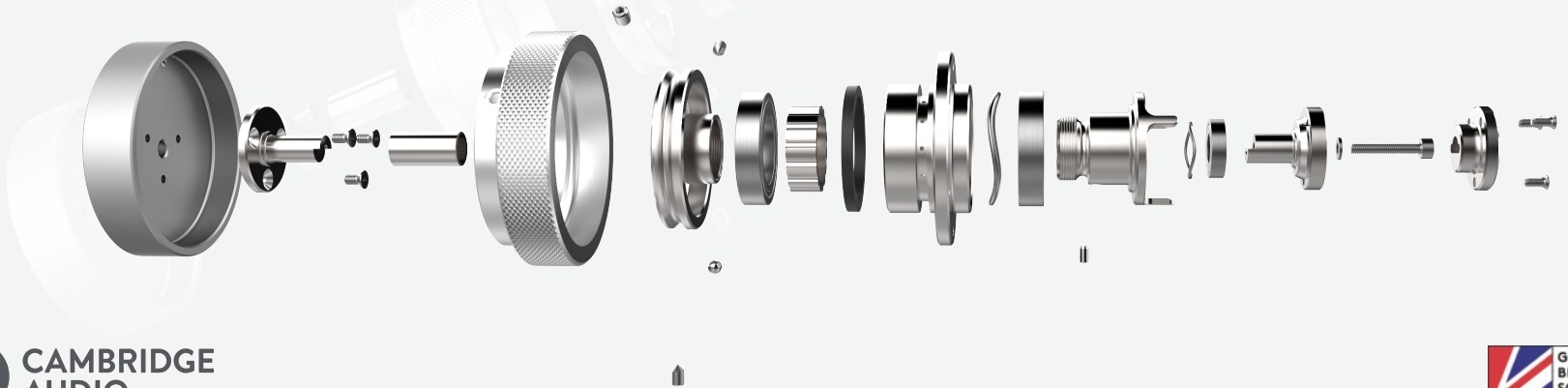

SONIC BALANCE

Edge A features a clean signal path that's perfectly balanced at any volume. To achieve this, our engineers...

- Replaced conventional capacitors with a DC coupled topology, which reduces distortion
- Solid-state volume control enables perfect channel balance.